

DECOMPRESSION UNITS

SQS

DECOMPRESSION UNIT WITH CHANGE OVER

INDUSTRIAL
GASES



The SQS semi-automatic unit prevents downtime by automatically switching gas supply from the primary cylinder bank to the reserve cylinder bank. The primary bank can be resetted by turning the lever. Manual adjustment of the individual regulators is not required.

APPLICATIONS:

- Technical applications;
- Automation;
- Industrial processes;
- Welding and laser cutting machines;
- Heating and burning systems.

FEATURES:

- Spring loaded diaphragm;
- Recommended for non-corrosive gases;
- Suitable for oxygen use;

MATERIALS

Pressure regulators	Brass
High pressure valve	Brass
Pipes	Copper 10x8
Diaphragm	EPDM for O ₂ and inert gas HNBR for H ₂ , CH ₄
Piston	Brass (range 28-30 bar)

COMPONENTS:

- Nr 2 shut-off valves with non- return valves on inlets
- Nr 2 pressure regulators
- Nr 2 high pressure gauges for detecting the supply pressure
- Nr 1 pressure gauge for detecting the output pressure
- Nr 2 purge valves
- Nr 1 lever to prioritize the supply line
- Nr 1 retaining frame of stainless steel
- All components are degreased for using Oxygen

TECHNICAL DATA

P. max Inlet	220 Bar
Range pressure out	10-8 / 32-28 Bar / 45-50
Flow rate	400 m ³ /h to 10 bar
Weight	20 kg / 44 lb
Working temp.	-20°C to +80°C
Conformity to Directives	PED 2014/68/ EU

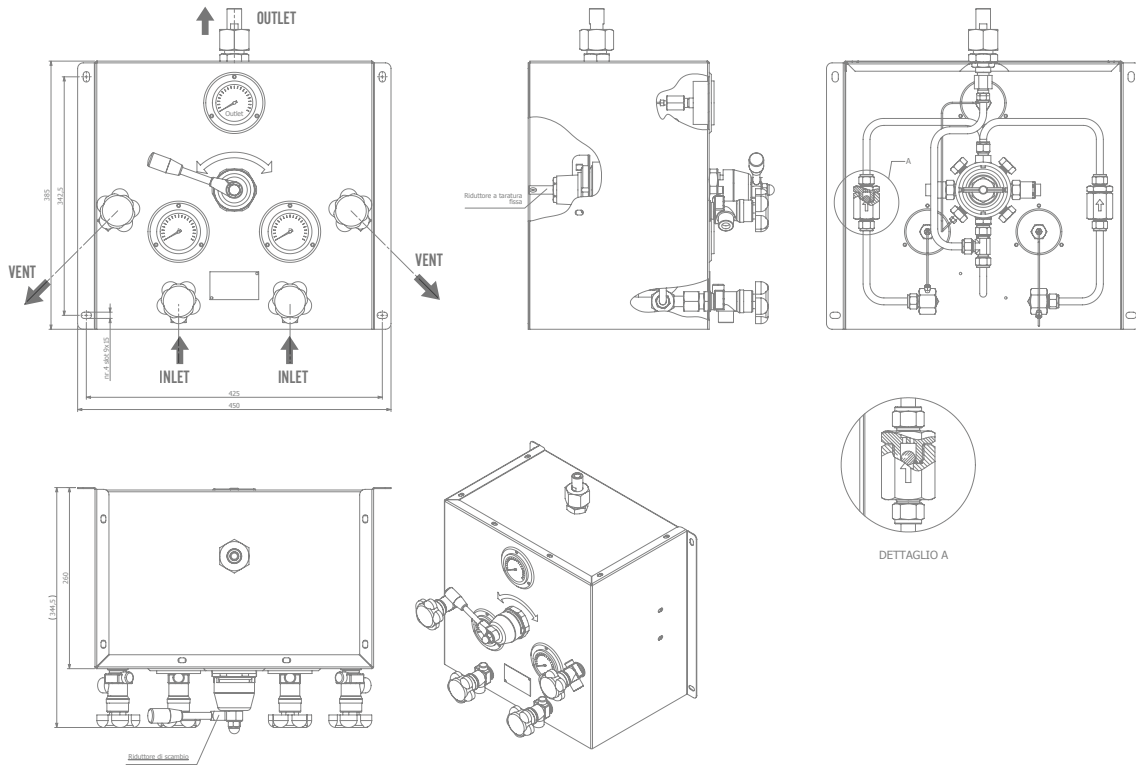

FLOW CHART

Diaphragm version

FLOW RATE

Piston version

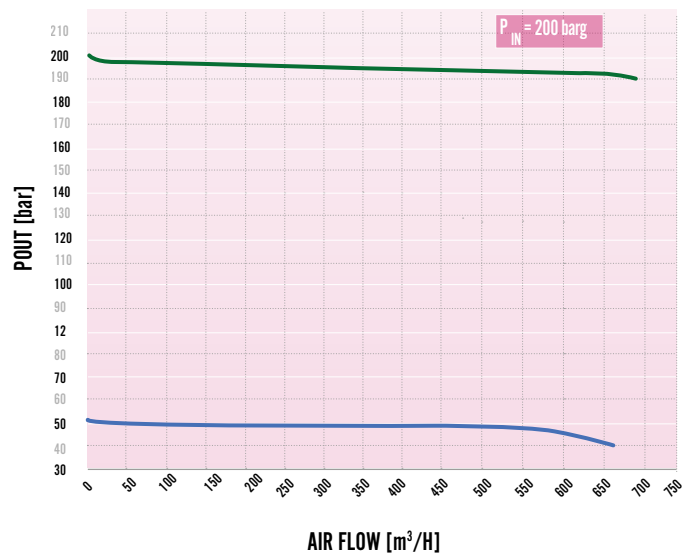
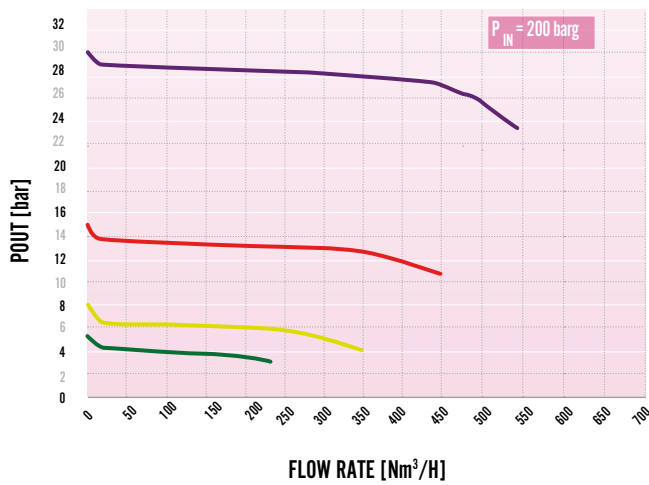

Code	Gas	Conn.Intel	Conn.Outlet	Press. In	Press. Out	Inlet Gaug	Outlet Gaug	Flow	Dim.(LxPxH)
SQSM0015N	O2-N2-Ar e-Aria-CO2	2-UNI 11144	1/2" GM	220 bar	10÷8 bar	0÷400 bar	0÷25 bar	100 Nm3/H	450x350x450
SQSM0017N	H2-CH4	2-UNI 11144	G 1/2" GM	220 bar	10÷8 bar	0÷400 bar	0÷25 bar	100 Nm3/H	450x350x450
SQSM0050N	O2-N2-Ar e-Aria-CO2	5-UNI 11144	1/2" GM	220 bar	32÷28 bar	0÷400 bar	0÷100 bar	210 Nm3/H	450x350x450
SQSM0051N	H2-CH4	7S-UNI 11144	1/2" GM	220 bar	32÷28 bar	0÷400 bar	0÷100 bar	210 Nm3/H	450x350x450

The outgoing calibration pressure can be customized when ordering