

PRESSURE REGULATORS SECOND STAGE

INDUSTRIAL
GASES



SRE 280L

PRESSURE REGULATOR REGULATOR STANDARD SERIES FROM 3/4" TO 1 1/2" 40 BAR

Pressure regulators of brass with adjustment system membrane. Balanced shutter to keep the pressure constant and almost complete independence of the primary pressure. In versions for Air complete system for self relieving the pressure discharge. Pressure range from 0.5 to 6, 10, 16 and 25 bar. Adjustment by knob. Complete with pressure gauge for reading outlet pressure Special models (ie, without relieving sel) on request. The gauges can be mounted on both sides. Important: It is always recommended to use filter upstream

APPLICATIONS:

- Technical applications;
- Automation;
- Industrial process;
- Welding and laser cutting machines;
- PET bottles and plastic items molding;
- Heating and burning systems.

FEATURES:

- Spring loaded diaphragm;
- Recommended for non-corrosive gases;
- Suitable for oxygen use.

MATERIALS

Body	Brass
Bonnet	Zinc alloy 406C Brass 280L 280M
Seals	NBR
Diaphragm	NBR
Internal parts	Brass
Shutter	NBR

TECHNICAL DATA

SRE280L

Port thread	3/4" or 1"
P. inlet max	40 Bar
Range pressure out	0.5-3 / 0.5-6 / 0.5-16/ 5-25 Bar
Gauge connections	1/4" BSP F
Self-relieving	yes (only air version)
Flow rate *)	7830 NI/min
Hysteresis control	~ 1 bar
Weight	3.5 kg/7.7 lb
Working temp.	-20°C to +90°C (NBR)
Conformity to Directives	PED 2014/68/ EU

*) PIN 8bar, POUT 6 bar, ΔP 1bar

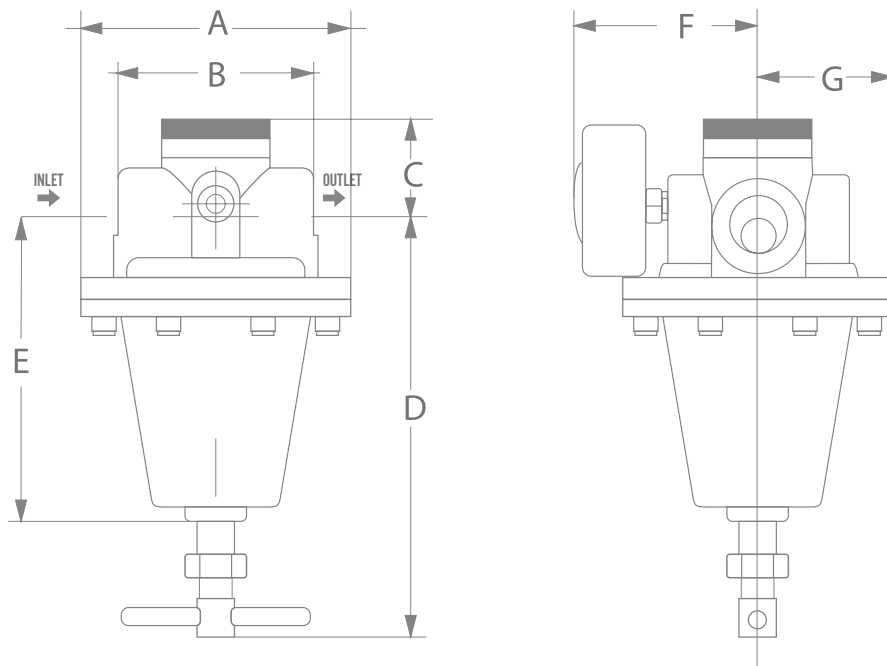

SRE280L

DIMENSION	G3/4*	G1*
A	116	116
B	95	83
C	41	41
D	175	78
E	-	-
F	80	80
G	58	58

FLOW RATE SRE280L | Large

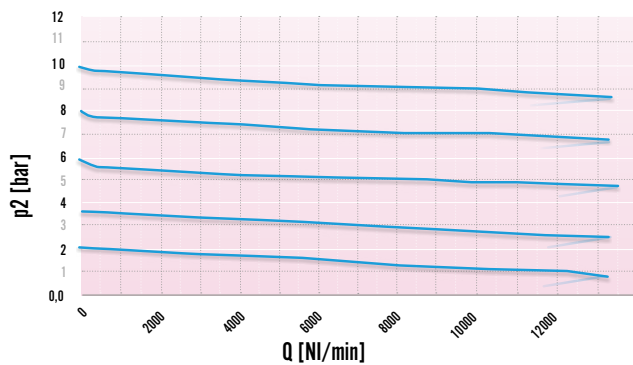

ACCESSORIES :

SERIES	SRE280L
Bracket	X
Panel mounting	-
Dimension lock nut	-