

PRESSURE REGULATORS SECOND STAGE

INDUSTRIAL
GASES



SRE 417

PRESSURE REGULATOR STANDARD SERIES FROM 1 1/2" TO 2" 40 BAR

Pressure regulators of brass controlled by diaphragm, with servomechanism for adjusting outlet pressure. Balanced shutter, to keep the outlet pressure almost constant and independent from fluctuation of inlet pressure. In versions for Air service, self-relieving execution for discharging over-pressure. Pressure range from 0.5 to 6, 10, 16 and 25 bar. Adjustment by knob. Complete with 2 pressure gauges for detecting inlet and outlet pressure. Special models (ie, without self-relieving exe.) on request. Important: upstream filter is strictly recommended

APPLICATIONS:

- Technical applications;
- Automation;
- Industrial process;
- Welding and laser cutting machines;
- PET bottles and plastic items molding;
- Heating and burning systems.

FEATURES:

- Spring loaded diaphragm;
- Recommended for non-corrosive gases;
- Suitable for oxygen use.

MATERIALS

Body, bonnet	Brass
Seals	NBR
Diaphragm	NBR
Internal parts	Brass
Shutter	NBR

TECHNICAL DATA

	1 1/2"	2"
Port thread	1 1/2" BSP F	2" BSP F – 2" NPT F
P. max Inlet	40 bar	
Range pressure out	0.5-6 / 0.5-10 / 0.5-16 / 5-25 bar	
Gauge connections	1/4" BSP F	
Self-relieving	Yes	
Flow rate*	25000 NI/min	
Hysteresis control	~ 0,5 bar	
Weight	5.5 kg	2.3kg/5lb
Working temp.	-20°C to +90°C (NBR)	
Conformity to Directives	PED 2014/68/ EU	

*PIN 8bar, POUT 6 bar, ΔP 1bar

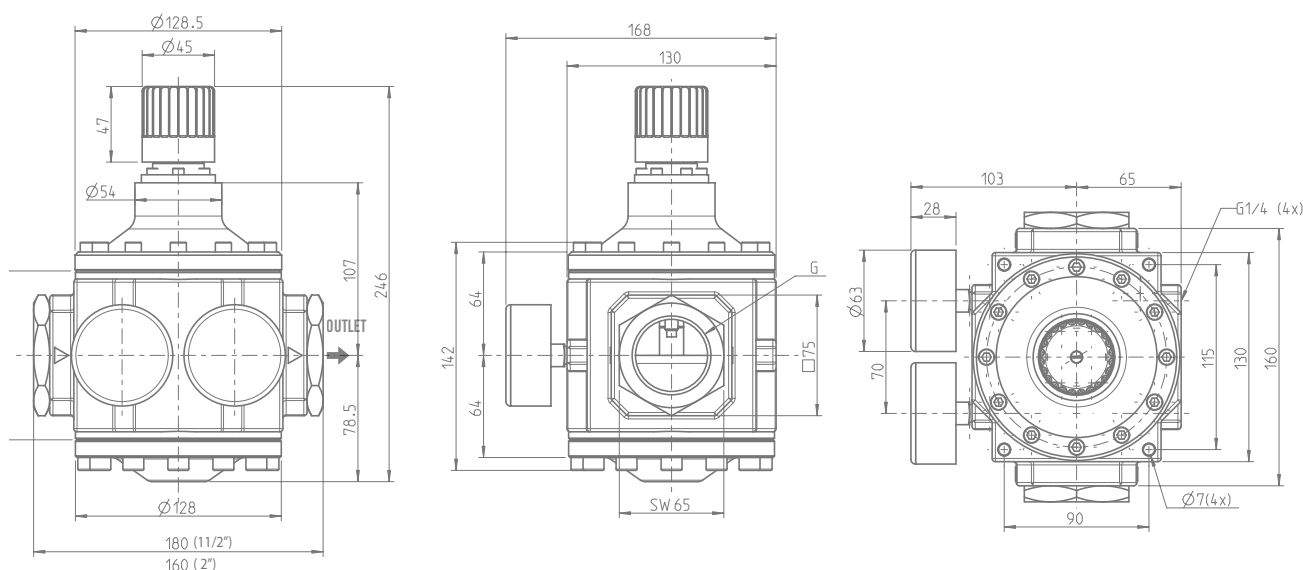

FLOW RATE

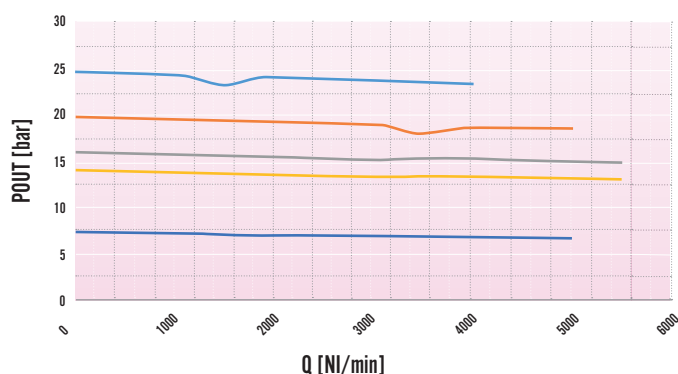

Code	Gas	Inlet Conn	Outlet Conn	Inlet pressure	Out. Press	Gauge
SRE4179GCOS01	02-N2-Ar-He-Co2-H2-CH4-GPL	2"	2"	40 bar	0.5-10 bar	0-16 bar
SRE4179GDOS01	02-N2-Ar-He-Co2-H2-CH4-GPL	2"	2"	40bar	0.5-16 bar	0-25 bar
SRE4179GEOS01	02-N2-Ar-He-Co2-H2-CH4-GPL	2"	2"	40bar	0.5-25 bar	0-50 bar

OPTIONALS :

- Bracket
- Flanges (EN1092-1/ANSI)
- Without relieving
- Dome loaded version
- Threaded hole for connecting gas venting on bonnet