

PRESSURE REGULATORS

TCR40B SERIES

HIGH PRESSURE REGULATOR FOR HIGH FLOW

INDUSTRIAL
GASES



Brass pressure regulators for high pressures and high flow rates. For models with outlet-pressure till 25 Bar, the control system is based on convoluted diaphragm, for a better stability and regulation; for models with output pressures higher than 25 bar, the system is controlled by pistons. The balanced shutter keeps the outlet pressure almost constant and independent from fluctuation of inlet pressure. Designed for the most critical applications such as big distribution plants and fire-fighting systems.

MATERIALS

Body	Brass
Bonnet	Brass
Seals	HNBR – EPDM – SILICONE - FKM
Diaphragm	HNBR – EPDM – SILICONE - FKM
Internal parts	Brass
Shutter	PTFE FI10-02

APPLICATIONS:

- Technical applications;
- Automation;
- Industrial processes;
- Welding and laser cutting machines;
- Heating and burning systems.

FEATURES:

- Spring loaded diaphragm;
- Recommended for non-corrosive gases;
- Suitable for oxygen use;

TECHNICAL DATA

P. max Inlet	300 Bar optional 400 Bar
Range pressure out diaphragm	1,5-15 / 2,5÷25 Bar
Range pressure out piston	5÷50 Bar / 20÷200 Bar optional 40-400 Bar
Inlet connections	¼" NPT F alternative bottle connections
Outlet connections	½" Gas M – ½" BSPP M
Flow rate	Membrana/Diaphragm ~ 500 Nm ³ /h Pistone/Piston ~ 700 Nm ³ /h
Weight	Membrana/Diaphragm 3.9 kg Pistone/Piston 4,1 kg
Working temp.	1-20°C to +100°C*
Conformity to Directives	2014/68/EU PED

[*] In case of different ranges of temperature please contact our technical department

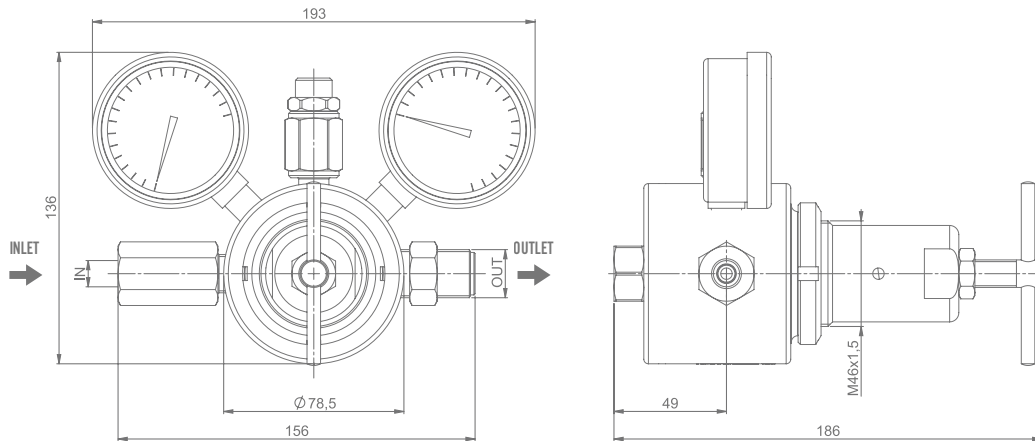

SPECIFICATIONS:

Inlet port	1/4" NPT - 1/4" NPT - Norme UNI - DIN - CGA - NEF - BS
Outlet port	1/2" BSPP - M o alternative 1/2" NPT - F
Weight	3,9 - 4,1 kg
Temperature range	-30°C to +74°C

FLOW CHART Serie: TCR40 Diaphragm version

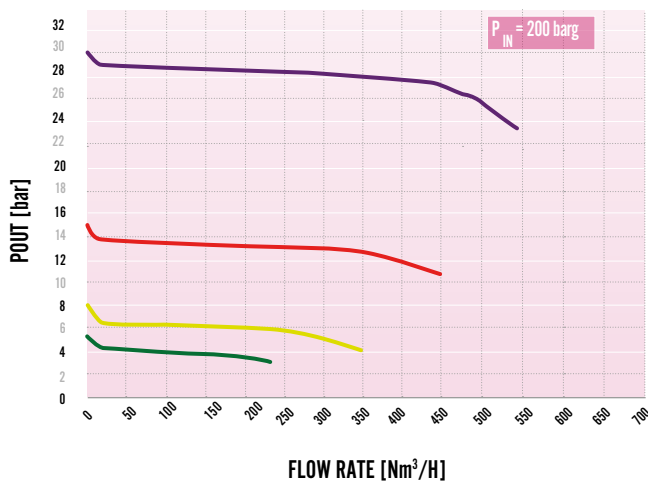

FLOW RATE Serie: TCR40 Piston version

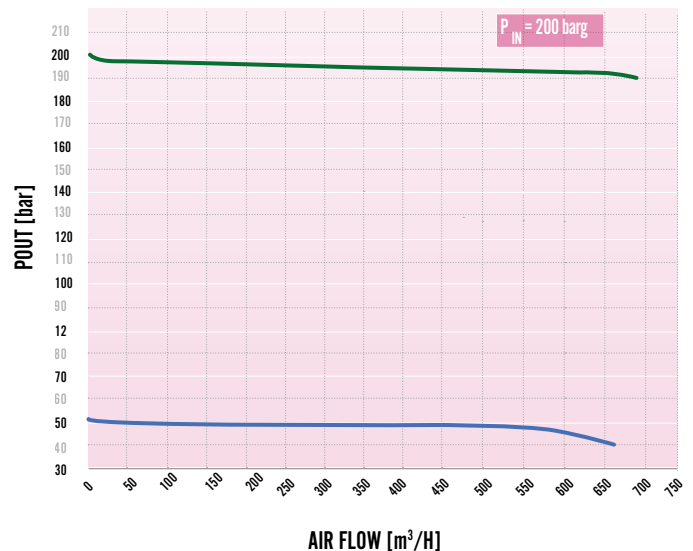

OPTIONALS:

- Inlet connections for cylinders
- Flanges (EN1092-1/ANSI)
- With relieving
- Execution for liquids
- Threaded connection to exhaust gas on bonnet
- Lock nut M 46X1,5 cool ARR00167